

Coco Palms Renovation

Construction and Demolition Debris Management Plan

Prepared by:

Kent Amshoff

Layton Construction

January 2023

EXHIBIT "14"

1. OVERVIEW

Layton Construction's scope of work for the Coco Palms Re-Development includes interior and exterior demolition. Part of Layton's company mission is to divert as much debris as possible from the local solid waste landfill. Accordingly, this plan summarizes the waste streams anticipated to be generated during demolition and the handling and disposal of each waste stream.

2. WASTE STREAMS

Layton anticipates that there will be a total of (8) waste streams generated during the renovation activities at the Coco Palms Project. The type of waste stream and disposal location are summarized below:

Concrete: all concrete debris (including tile, stone, and rock) will either be stockpiled at a location within 5 miles of the project site and crushed into aggregate for reuse at the project OR it will be taken to a permitted recycling yard located in Lihue.

Asphalt: all asphalt will be taken to a permitted recycling yard in Lihue.

Green waste: all green waste will be taken to Heart and Soul Organics in Moloaa.

Metal (ferrous): all ferrous metal will be taken to Resource Recovery Solutions for recycling in Lihue.

Metal (non-ferrous): all non-ferrous metal will be taken to Resource Recovery Solutions in Lihue for recycling.

Cardboard: all cardboard will be taken to Garden Island Disposal in Lihue for recycling.

Asbestos: all asbestos debris will be properly containerized and shipped to PVT Landfill on Oahu for disposal.

General construction debris: all general trash generated on the project site, including wood, plastic, etc., will be taken to Kekaha Landfill for disposal.

All materials removed from the site will be properly scaled and recorded on the attached Waste Management Tracking form.

3. SEGREGATION OF WASTE STREAMS

Layton will provide separate debris bins for each of the waste streams generated. Each bin will be labeled to clearly denote the waste materials within. As part of the interior demolition work, debris will be separated into separate waste streams within the work area. Segregated loads of either concrete, metal, or general debris will be transported to the appropriate debris bin. When asbestos abatement work is performed, all asbestos will be placed into a dedicated asbestos bin. For the exterior work, the asphalt, concrete, and green waste will be segregated into separate bins and/or trucks.

4. ANTICIPATED QUANTITIES – DEMOLITION ONLY

Concrete & Asphalt: Crushed and Recycled on-site; approximately 12,500 Tons

Asphalt/Cardboard/Green Waste: Crushed/Mulched/Recycled; approximately 1,000 tons

Metal Waste – Collected and Recycled at Resource Recovery Solutions; approximately 200 tons

General Construction Waste to Landfill: 1,000 tons

Anticipated Demolition Scope on Project (see attached drawing): Existing concrete structures 1, 2, & 3 along Kuhio Highway will have the Roof, Level 3, and Level 2 slabs/columns demolished.

5. DEMOLITION SCOPE

See attached Coco Palms Site Plan and summary of each structure below:

- The three concrete structures along Kuhio Hwy are labeled Building 1, 2, and 3. The concrete slabs and columns on Roof, Level 3, and Level 2 will be demolished to the First floor slab.
- Lobby Building 4 has already had a lot of demolition occur several years ago. The existing wood structure on the Lihue side will be demolished. Any old wood structures or attachments will be removed.
- King's Cottages labeled Building 5 have already been demolished several years ago down to the slab on grade. Slab on grade concrete will be cut-up and removed
- Queen's Cottages labeled Building 6 have already been demolished several years ago down to the slab on grade. Slab on grade concrete will be cut-up and removed
- Prince's Cottages labeled Building 7 have already been demolished several years ago down to the slab on grade. Slab on grade concrete will be cut-up and removed
- King Lagoon Building 8 have already been demolished several years ago down to the slab on grade. The slab on grade and one standing concrete wall will be cut-up and removed.
- Queen's Lagoon Building 9 has already been demolished entirely several years ago.
- Lobby Building 10 has already had most materials demolished several years ago. The existing structural concrete slab and walls will have minimal demolition and replacement.
- Retail Building 11 will have all wood siding, windows and roofing removed and demolished. The structure will remain and be reinforced with new plywood sheathing and siding + roofing.
- Queen's Audience Hall Building 12 will have siding and rotten wood components + roofing removed and replaced. Existing structure will remain and be reinforced.
- House in the Palms Building 13 has already been demolished several years ago down to the slab on grade. Select demolition of the slab on grade will be cut-up and removed. There is no new construction contracted at this time for this Building.

- Palms Lana Building 14 has already been demolished several years ago and all concrete and structures removed. There is no new construction contracted at this time for this Building.
- Warehouse Buildings 15 & 16 have already been demolished several years ago and all concrete and structures removed. There are minimal small slab on grades that will be cut-up and removed. There is no new construction contract at this time for these buildings.
- Shell Restaurant Building 17 will have rotten siding, roofing and wood removed and replaced with new materials. Existing structure to be reinforced and repaired.

6. ANTICIPATED SCHEDULE FOR DEMOLITION

Demolition of the existing concrete structures is slated to begin in May of 2023. This will last approximately 3 months and finishing in August 2023. New construction will begin at this point and expected waste from new construction activities will begin and last for 2 years completing in the summer of 2025. A new Construction Waste and Demolition Debris Management Plan will be submitted for the new construction.

7. RECORD KEEPING & REPORTING

All construction debris that is diverted or disposed shall be tracked and records kept. This includes load and weight tickets. At the conclusion of the project, a final report listing all diversion or disposed materials will be produced and submitted for record to the City and County Solid Waste Division.

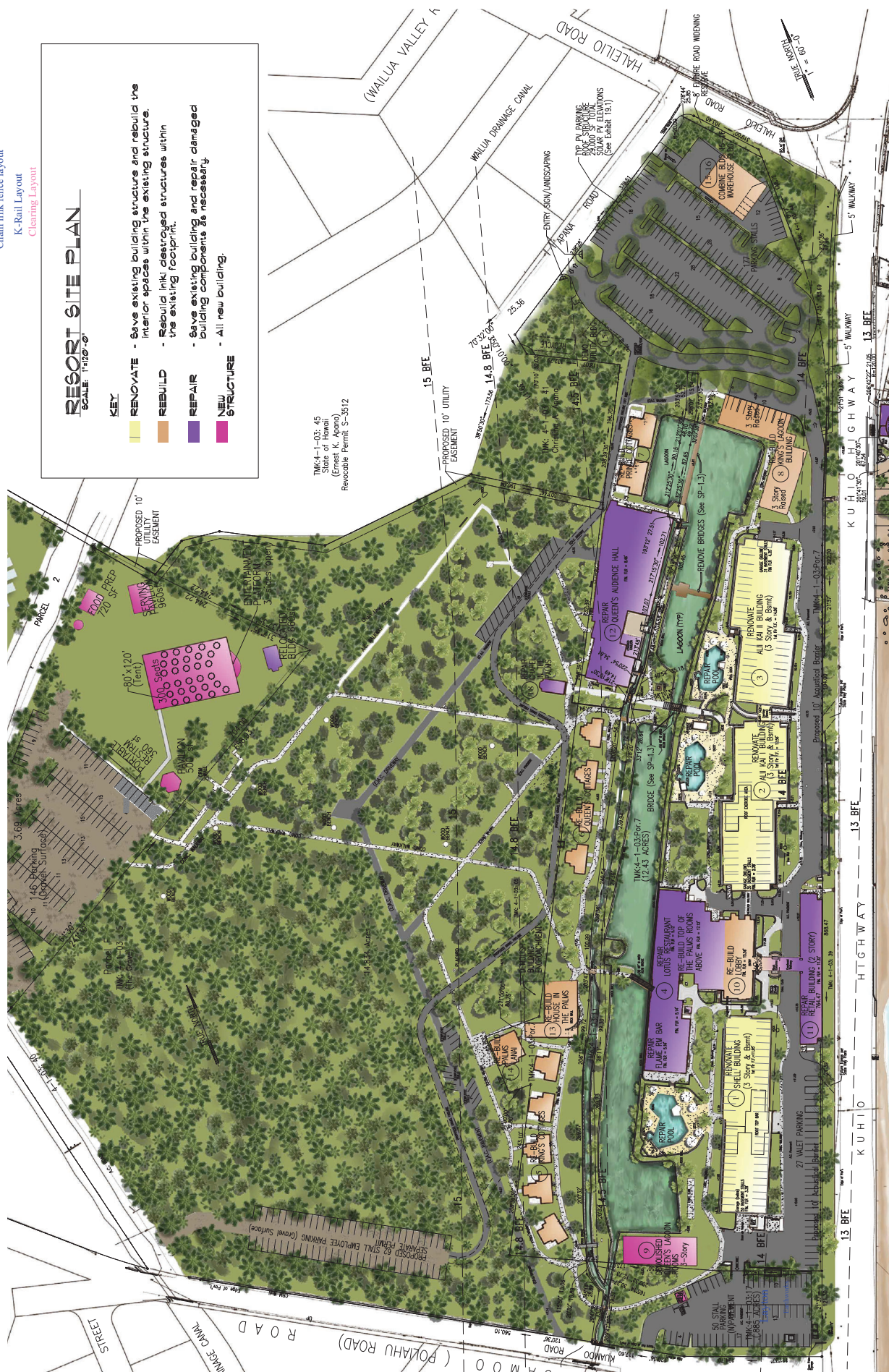

Pacific Concrete Cutting & Coring, Inc.

Waste Management Tracking

Pick -Up Date										
	Bin #/ Truck #	Material	Recycle Location	Recycle Tonnage	Disposal Location	Disposal Tonnage	Waste Ticket #	PCCC Ticket #	Notes	

Disposal locations:

- Concrete-
Asphalt-
Green Waste-
Metal- (ferrous)
Metal- (non-ferro
Metal-
Cardboard-
General trash-
- PCCC Recycling Yard
PCCC Recycling Yard
Heart and Soul Organics
Resource Recovery Solutions
Resource Recovery Solutions
Schnitzer Steel
Garden Island Disposal
Kekaha Landfill